



WESSEX 'Elesse'

Elesse



Technical Sales Specification

(LS01 5120)



©Copyright 2016

Wessex Lift Co Ltd

All Rights Reserved

Except as expressly provided below, no part of this manual may be reproduced, copied, transmitted, disseminated, downloaded or stored in any storage medium, for any purpose without the express prior written consent of Wessex. Wessex hereby grants permission to download a single copy of this manual and of any revision to this manual onto a hard drive or other electronic storage medium to be reviewed and to print one copy of this manual or of any revision hereto, provided that such electronic or printed copy of this manual or revision must contain the complete text of this copyright notice and provided further that any unauthorised commercial distribution of this manual or any revision hereto is strictly prohibited.

Information in this document is subject to change without notice. Wessex reserves the right to change or improve its products and to make changes in the content without obligation to notify any person or organisation of such changes or improvements

Bentley Mobility Services Ltd



Unit 19 Highview Business Centre
High Street
Bordon
Hampshire GU35 0AX

T: 01420 470730
F: 01420 470731
W: www.bentleymobility.co.uk

RECORD OF REVISIONS

Revision	Revision Date	Description	ECO
1	30/07/2012	Pre-Production Issue	
2	15/08/2013	Name change. Wireless call stations added. Powerpack update	
3	21/01/2014	Page 8 updated to include TÜV	
4	23/10/2014	3.5m rise & powerdoor option added & Ellesse Elite removed	
5	09/09/2016	Updated to reflect product changes and classifications	



CONTENTS

	Page
1. INTRODUCTION	4
2. PRODUCT RANGE & SPECIFICATION	5
2.1 Reference Documentation.....	5
2.2 Lift Car Dimensions	6
2.3 Aperture Dimensions	7
3. DOOR CONSTRUCTION & OPERATION	8
4. CONTROLS	8
4.1 Car Controls	8
4.2 Call Station Controls	9
4.2.1 Wireless Call Stations (Standard)	9
4.2.2 Hard wired Call Stations (Optional)	10
5. ILLUMINATION	10
6. TRACK SYSTEM	10
7. FINISH	10
8. ELECTRICAL REQUIREMENTS	10
9. BATTERY BACKED FEATURES	11
10. APPLICABLE STANDARDS	11
11. SAFETY FEATURES	11
12. OPTIONS	12
13. METHOD OF INSTALLATION	12
13.1 Building Works	12
13.2 Installation	13



1. INTRODUCTION

The drawing below shows a typical Ellesse installation. The Ellesse is designed for use in a domestic dwelling. The lift must not be fitted into bathroom environments or damp/humid conditions. The Ellesse has a double fire seal arrangement at the mid floor level.

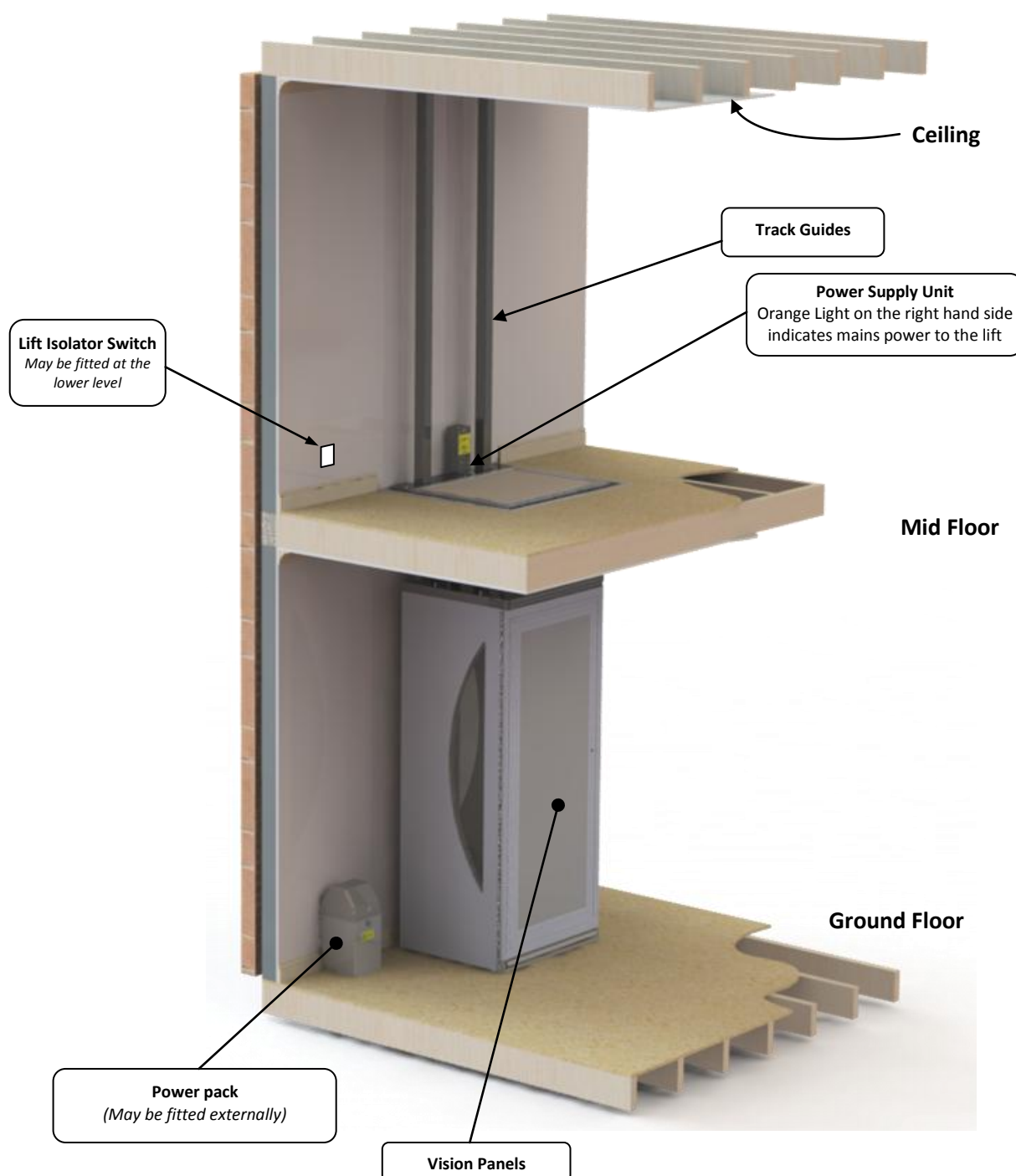



2. PRODUCT RANGE AND SPECIFICATIONS.

The table below details the standard specification for the Wessex “Elesse” range.

STANDARD SPECIFICATION	LS15	LS25
3000mm Maximum Travel	✓	-
3500mm Maximum Travel	-	✓
Minimum shaft width	1046mm	1046mm
Minimum Open shaft length	936mm	936mm
Mid-floor dimensions	165mm to 385mm	165mm to 385mm
Safe Working Load	250kg	250kg
Lift Speed	60mm/sec	60mm/sec
Door Adjustment	Up to 95°	Up to 95°
Internal Cabin Height	2000mm	2000mm
Minimum ground floor ceiling height	2080mm	2220mm
Minimum first floor ceiling height	2180mm	2315mm
Power Door	✓	✓
Rear Mirror	✓	✓
Handrails	✓	✓
Panoramic Door	✓	✓
Side Glazing	✓	✓
Roof Mounted LED Spot Lighting	✓	✓

2.1 Reference Documentation.

The table below details the technical information available for the Wessex ‘Elesse’ range. The following documents must be referred to before commencing any work.

Drawing No	Description
SK01 2101	Elesse Dimensions
SK01 2109	Elesse Aperture Dimensions
VM00 6012	Mid Floor Details 400mm Joist Centres
VM00 6013	Mid Floor Details 600mm Joist Centres
VM30 9001	Structural Loadings
VM30 9006	VM Electrical Instructions
VM30 9007	VM Electrical Instructions New Build
VM30 9004	Building Instructions Aperture cut-out Details
VM30 9009	Building Instructions for Shafted Lifts
VM30 9008	Floor Run Out
VM30 9005	Aperture Trim Fixing
VM00 2010	Track Installation Drawings
VM30 9002	Pump Information



2.2 Lift Car Dimensions.

If the gap between the tracks and the rear wall exceed 150mm downstairs and 100mm upstairs, a false wall (track infill) will be required. Nominal dimension is 75mm.

Note: Door Shown is Left Hand looking at lift, however this may be opposite

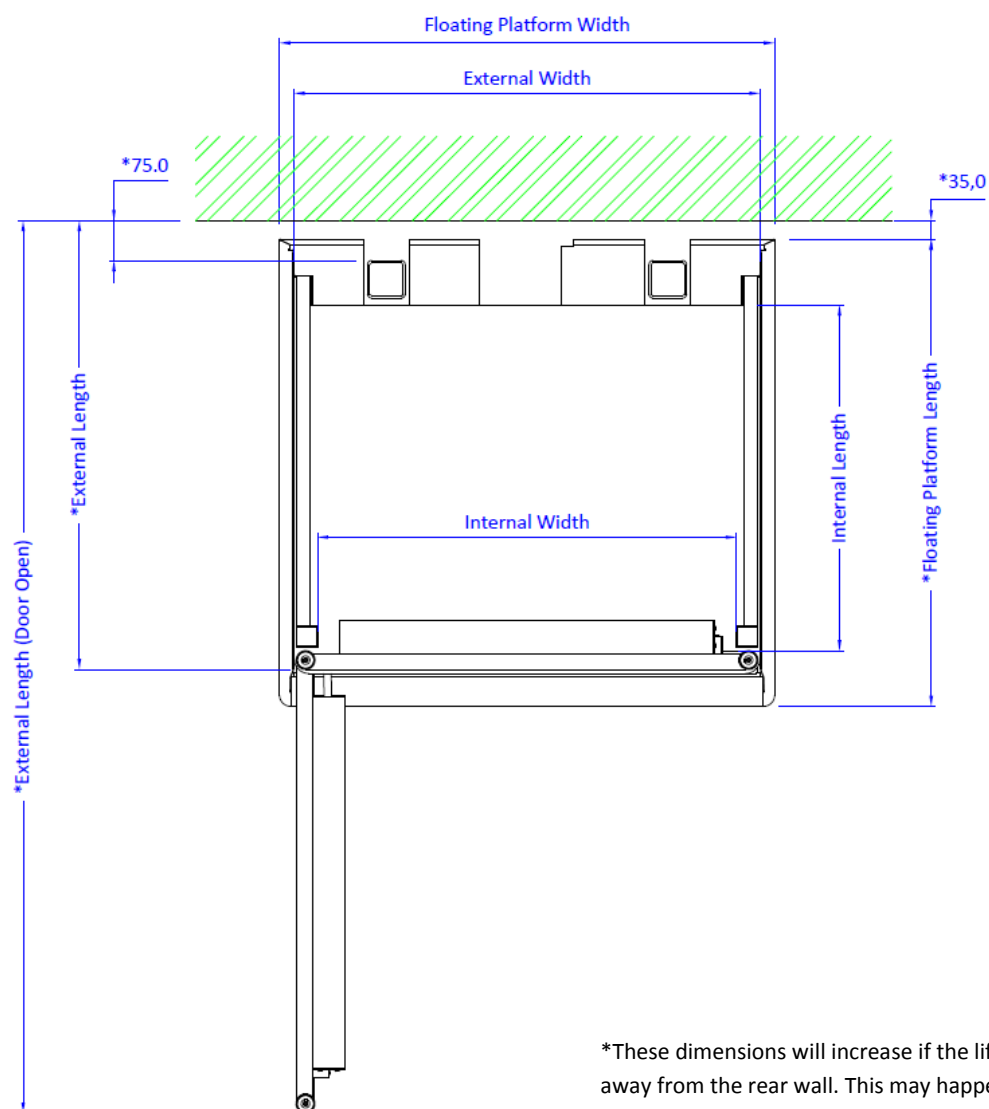

*These dimensions will increase if the lift is positioned away from the rear wall. This may happen if skirting boards etc... are not removed.

Model	Length				Width		
	Lift External	Lift Internal	Lift Door Open	Floating Platform	Lift External	Lift Internal	Floating Platform
LS15	840	585	1665	905	860	775	920
LS25	840	585	1665	905	860	775	920



2.3 Aperture Dimensions.

Refer to VM30 9004 for comprehensive aperture details, and VM30 9009 for shafted aperture details.

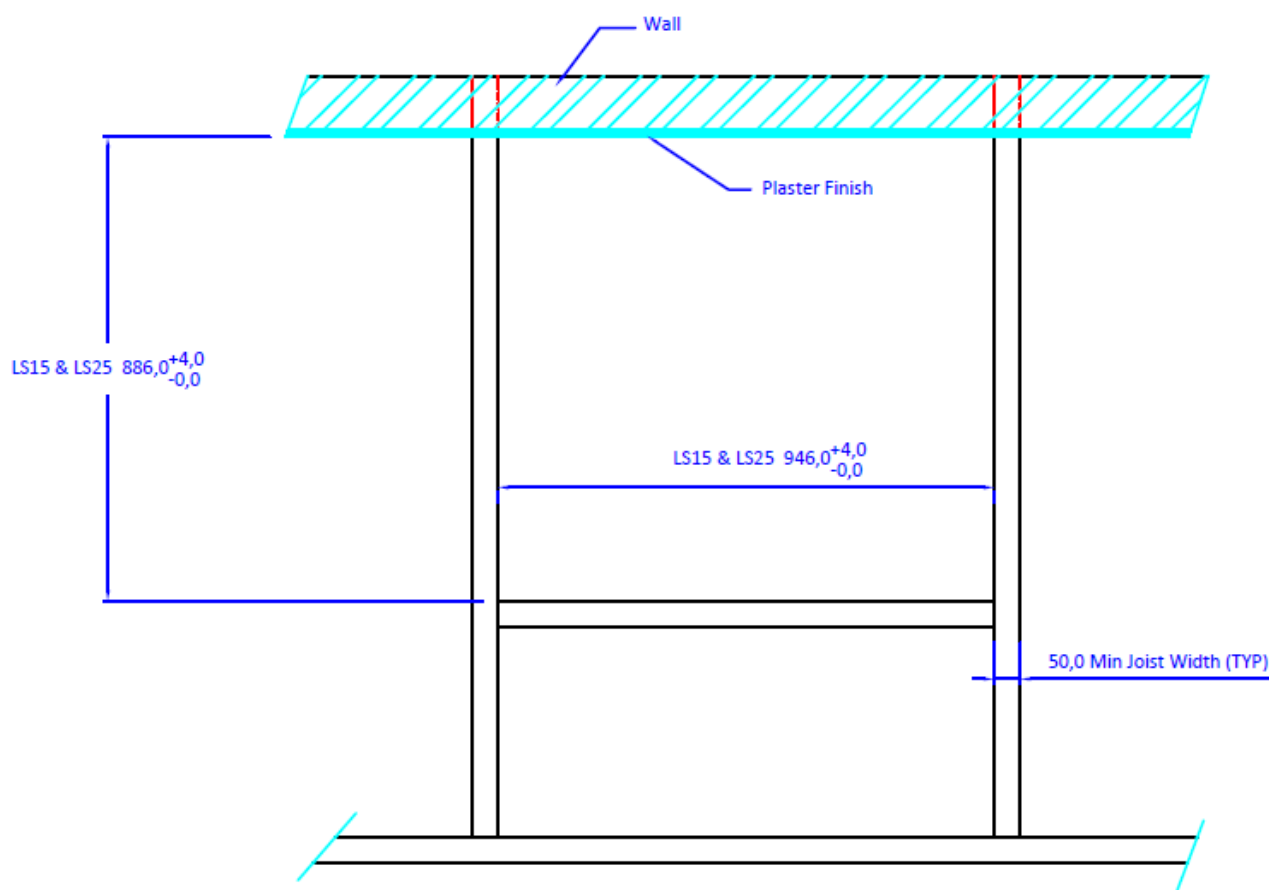

Aperture Plan View

The timber joists are always required as they form the structure to fix the steel aperture lining. Always use suitable joist hanger brackets and screw in place. Do not use nails under any circumstances. Refer to building works manual and drawings.



3. DOOR CONSTRUCTION AND OPERATION.

The Ellesse models have a manually operated door. The lock is held open for approximately 5 seconds, when the door button or door safety edge is pressed. This allows single handed operation of the door to release and open. The door opens up to a maximum of 95°.

4. CONTROLS.

The lift can be operated by using either, the In-car controls, upper level call station or lower level call station.

Auto-homing to first floor is optional. When the lift is at the ground floor, after a set period of time the lift will ascend to the upper level.

Wireless controls are available.

Hold to run controls are compulsory for TÜV (optional in the UK).

4.1 Car Controls.

The In-car controls can be fitted to either side of the lift car. The controls illuminate logically to indicate which functions are available. All illumination will extinguish after a set period of time to conserve energy. The push buttons and in-car lighting will illuminate when the door release button is pressed.

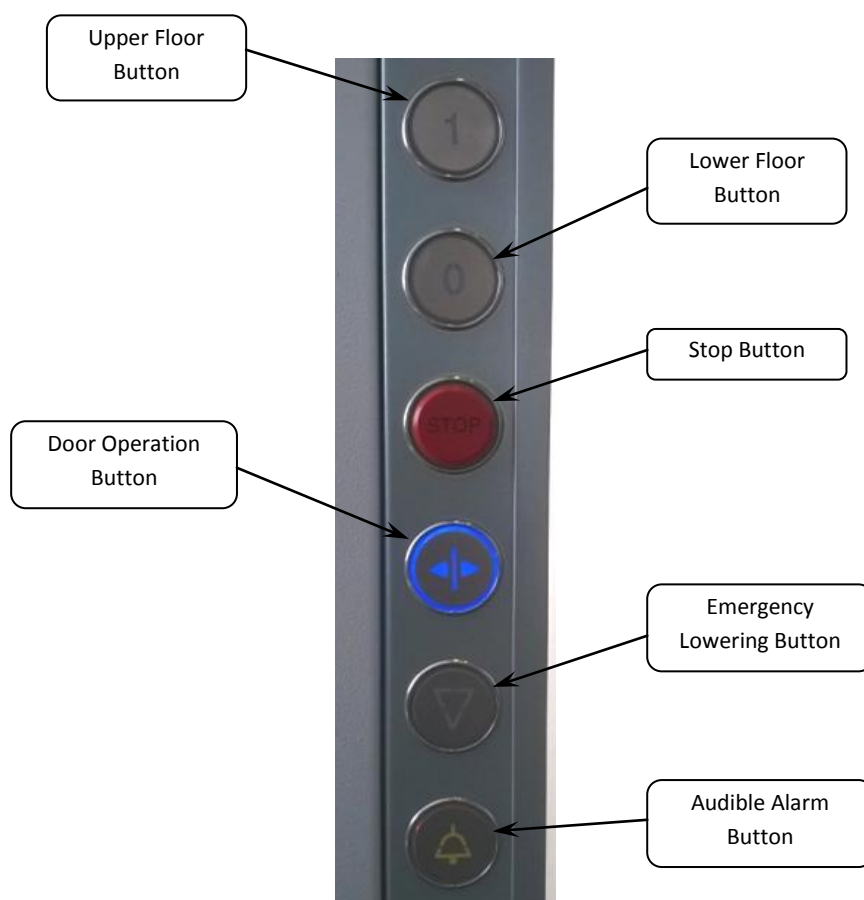



4.2 Call Station Controls.

4.2.1 Wireless call stations (standard)

The Ellese range of products uses the latest wireless technology for its landing call points.

The handset clips to a bracket attached to the wall. The estimated range of the handset within buildings is 20 to 40 metres. The handset uses three AAA batteries. Two handsets are supplied as standard. Further handsets can be added to the system as required.

If desired, the handset can be unclipped from its bracket and used as a portable handset to call or send the lift.

Key switches on wireless call stations are not available. However, once unclipped, the user can place the handset in a secure location to prevent unauthorised use. If a call station key switches is required, we recommend the hard-wired option is installed.

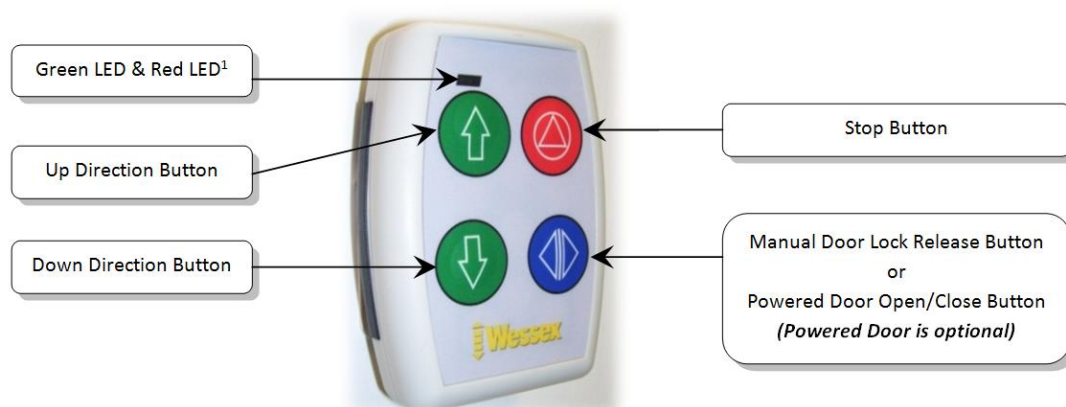

Note 1: The Green LED illuminates only when a button is pressed.
When the batteries are low, the Red LED will flash for 5 seconds after a button is pressed.



4.2.2 Hard-wired call stations (optional)

Hard-wired call stations are surface mounted but can be made flush finished by special request.

The call station controls do not illuminate. The lower call station wire is run through the mid-floor and vertically down the wall. The upper call station is run through the mid-floor and vertically up the wall.

Key-switches are optional but recommended for dwellings that require the lift controls to be isolated. This prevents unauthorised use by children.



4.2.2 Hard-wired call station

5. ILLUMINATION.

Low voltage LEDs mounted in the roof of the lift car. These have the same elapsed timer feature as the in-car push button illumination. The lights are triggered via any door control (or in the event of a power failure).

6. TRACK SYSTEM.

Fixings at ground floor, mid floor via structural beam and ceiling fix at first floor level. An optional wall bracket is available at the first floor level, if ceiling fixing is not achievable.

7. FINISH.

For internal domestic use only.

External panels powder coated textured finish to specification BS4800 22B-15 (Pearl Grey)

Internal panels powder coated. As standard (Sensual) with a further 3 choices from (Kura, Shilan, San Fransisco)

Flooring Options. Amtico Floor tile (Norwegian Slate, Jura Stone, Wild Walnut, White Oak)

See Product Brochure for colour panels

8. ELECTRICAL REQUIREMENTS.

Supply 230Vac 50Hz single phase earthed supply.

Power consumption:

- 24 hours on standby = 0.396 kWh
- One complete cycle = 0.015498 kWh
- VM full load running current = 4.2 amps

The supply must be dedicated solely to the lift and shall originate at the household consumer unit.

Must be RCD protected. Refer to VM30 9006 for full details.

Pre-payment coin metres are not recommended.



9. BATTERY BACKED FEATURES.

The following functions within the lift will still function in the event of a power failure:

- In-car emergency lowering will become active
- Floating platform safety switches
- Trap-board safety switches
- Illumination of car and push buttons
- Manual door release
- Powered door (if fitted)

10. APPLICABLE STANDARDS.

The Ellesse range is designed and meets all the essential health and safety requirements (EHSR) of the Machinery Directive 2006/42/EC and is CE marked accordingly.

The Ellesse in part meets the code of practice BS 5900: 2012 (the variation is that the lift car is fully enclosed rather than partially enclosed)

11. SAFETY FEATURES.

- Sensitive surface to car roof.
- Sensitive surface to car underside.
- Door electrically interlocked. Will only open when at the correct level.
- Power door breakout mechanism. Door will stop if obstructed.
- Manual door release key. The door can be manually opened in the event of a door release failure. This must only be used when the lift is either at the upper or lower level.
- Sensitive surface to trap-board sensing up and down obstructions.
- Separation and zone switches on trap-board.
- Fire seal when lift is upstairs.
- Pipe burst valve integral to base of hydraulic ram.
- Anti-creep and re-levelling facility at first floor.
- Low voltage 24V dc control system (PELV).
- Fire retardant materials throughout.
- Final limit switch.
- Overrun timer.
- Shoot bolt which maintains fire-seal when lift is parked upstairs if there is a hydraulic failure.
- In-car battery backed emergency lowering. The lift can be lowered to the ground floor by pressing the in-car emergency lowering button in the event of a power failure.
- Manual emergency lowering at the power pack. The lift can be lowered in the event of a power failure from the power pack. *Note: This procedure will only work if the lift is at least 50mm below the upper level.*



12. OPTIONS.

- **Handrails** – Side mounted positions available. These handles allow the user points on which to ease themselves into the Lift car.
- **In-car Lighting** – Internal illumination of the Lift car is provided which automatically switches off when the lift is not in use. The lighting is operational via battery back up in the event of a power failure. This is fitted as standard.
- **In-car Seating** – An in-car seat option is available. Maximum rated load of the seat is 150kg. The seat can fold up neatly away by simply lifting the front edge of the seat up until it is in the vertical position.
- **Hard wired call stations** – Hardwired call stations available to control most functions of the Lift.
- **Telephone** – An in-car telephone option is available.
- **Auto-homing** – An auto-homing option is available. This will automatically send the Lift to the upper level after a set period of time when the door is in the closed position. ('Homed' position).
- **Auto-door Closing** – An auto-door closing option is available. This will automatically close the Lift door after a set period of time.
- **In-car Key-switch** – An in-car key-switch option is available. This will disable the up, down and stop button on the in-car control panel. This option must only be used if the user of the Lift is not physically or mentally able to use the in-car controls. The Lift must be supervised at all times when in use.
- **Smoke Alarms** – Mains powered (battery backed) smoke alarms are available. The smoke alarms are connected to the lift and will call the Lift to the upper level if triggered in the event of a fire. Please note the lift door must be closed for this to work.
- **Wall Mounted Controls with a Key-switch** – Wall Mounted Controls with a Key-switch option is available. Key-switches are optional but recommended for dwellings that require the lift controls to be isolated. This prevents unauthorised use by children. The up and down buttons can be turned off, but the door button (*if fitted*) will remain active. Hardwired call stations only.

13. METHOD OF INSTALLATION.

There are 2 steps to installing any product from the Ellesse range:

- The building work (forming aperture and fitting the aperture liner & trap-board) (Approx 2 days).
- Track system and lift installation. (Approx 2 days).

13.1 Building works.

A builder and Electrician will be appointed at placement of order. The builder will be responsible for forming the aperture, fitting the aperture lining components, removing skirting, dado and any picture rails where necessary. A qualified electrician will install the mains power to the lift at the same time. This will involve fitting a RCD protected dedicated supply from the main distribution board.



13.2 Installation.

The installation engineers will cut and fit the tracks and lift car and then commission the lift.

The benefits to this approach are:

- Standard track lengths allows batch production of both top and bottom track components.
- Despatch for regional and agents stock holding of tracks becomes feasible with this method of manufacture and design.
- The complete package can be project managed and controlled by Wessex Lift Co Ltd.

The basic installation sequence (which will form part of the Method Statement) after the builders work has been completed is as follows: -

Basic Build Sequence

1. Fit Tracks
2. Fit Ram and ram housing along with power pack
3. Attach lift car on tracks in the following order; -
 - Carriage
 - Sides
 - Floor
 - Adjust and set tensioning devices
 - Floating Platform
 - Electrical Connections
 - Trap board and front pick up mechanisms
 - Panel out car
 - Fit seat if applicable
 - Fit handles if applicable
 - Fit phone if applicable

Bentley Mobility Services Ltd



**Unit 19 Highview Business Centre
High Street
Bordon
Hampshire GU35 0AX**

**T: 01420 470730
F: 01420 470731
W: www.bentleymobility.co.uk**